

EVO vs.7-v1

48v

5.7 kwh



CE Approved

UN38.3

Features



Product Warranty

EVO vs.7-v1 Series lithium-iron battery is covered by a product warranty of 10 years*1

Wall Mount

Simplify Installation, saving you time with sturdy wall ear points for securing the battery*2

Evo is a global player in the solar energy sector. Products may vary slightly from their pictures: The images of the products in our catalogues are for illustrative purposes only. Although we have made every effort to display the colours and images accurately, we cannot guarantee that a device's display of the colours accurately reflects the colour of the products. Your product may vary slightly from those images. *1 warranty based on product registration. *2 please make sure the wall is strong enough to handle the load of the battery

EVO v5.7

Battery	Data Specifications
Energy Capacity [kWh]	5.760kWh
Usable capacity [kWh]	5.760kWh
Max Continues Discharge Power [kWh]	7.2KW
Current Capacity [Ah]	120Ah
Max & Recommended Charge Current [Ah]	100Ah/150Ah
Max & Recommended Discharge Current [Ah]	150Ah/100Ah
Nominal Voltage	48VDC
Cut off Voltage [VDC]	45VDC
Bulk Charge/ Float Charge [VDC]	53.5VDC/ 52.5VDC
Working Temperature [°C]	-10°C to 55°C
Communication	RS485 / CAN (CAN H4; CAN L5)
Parallel	Up to 15 Units
Storage Temperature Long Term [°C]	-20°C to +35°C (<1 Year, SOC: 20% - 60%)
Elevation [meters]	≤4000m
Dimension of actual unit/ weight [mm/kg]	650L x 475w x 190h / 68.5kg
Dimensions boxed [mm/kg]	670L x 490w x 220h / 70kg
Enclosure	Aluminum, IP21
Accessories Not Included	25mm cable 1 meter (1x red, 1x black)
Product Warranty*1	10 years (subject to product registration)

Smart BMS with OVP/UVP/DOCP/COCP/SCP/OTP Protection and Balancing

Communicates with all major inverter brands Growatt, Must, INVT, DEYE, Megarevo and SMK

LCD Display with indication of SOC, VDC, Ah, Status, Current, Temp, Protection status, Cycles and Cell Rating. Wall mounting for simple installation

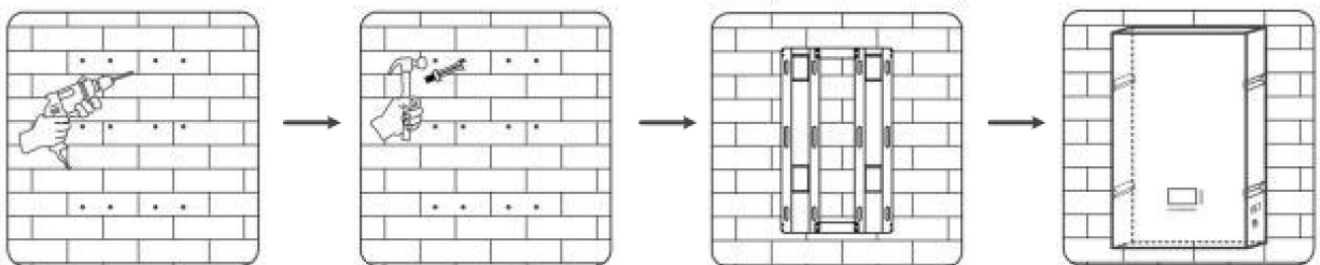

Evo is a global player in the solar energy sector. Products may vary slightly from their pictures: The images of the products in our catalogues are for illustrative purposes only. Although we have made every effort to display the colours and images accurately, we cannot guarantee that a device's display of the colours accurately reflects the colour of the products. Your product may vary slightly from those images. *1 warranty based on product registration. *2 please make sure the wall is strong enough to handle the load of the battery